

TREX SIGNATURE® HORIZONTAL MESH RAILING

Installation Instructions



NOTES:

- » TREX SIGNATURE MESH RAILINGS ARE DESIGNED TO BE ATTACHED WITH POSTS INSTALLED AT A MAXIMUM CLEAR SPAN OF 6' (1.83M) OR 8' (2.44M).
- » MUST USE TREX DECK MOUNT POST HARDWARE AND METAL PLATE WHEN ATTACHING SIGNATURE POSTS IN GUARDRAIL APPLICATIONS.
- » FOR FULL SPAN INSTALLATIONS, MESH WILL NOT NEED TO BE CUT WITH THE EXCEPTION OF 6' X 42". IF INSTALLING AT THIS SIZE, PURCHASE 8' X 42" MESH AND CUT TO THE PROPER LENGTH.
- » ALWAYS REFER TO YOUR LOCAL BUILDING CODE OFFICIAL PRIOR TO INSTALLING ANY RAILING SYSTEM TO ENSURE ALL CODE AND SAFETY REQUIREMENTS ARE MET. TREX CANNOT BE HELD RESPONSIBLE FOR IMPROPER OR NON-RECOMMENDED INSTALLATIONS.
- » A FOOTBLOCK IS REQUIRED FOR ALL SPANS OF TREX SIGNATURE MESH RAIL.
- » ENSURE THAT EACH MESH PANEL IS ORIENTED IN SAME DIRECTION FOR EACH SECTION PRIOR TO BEING INSTALLED.

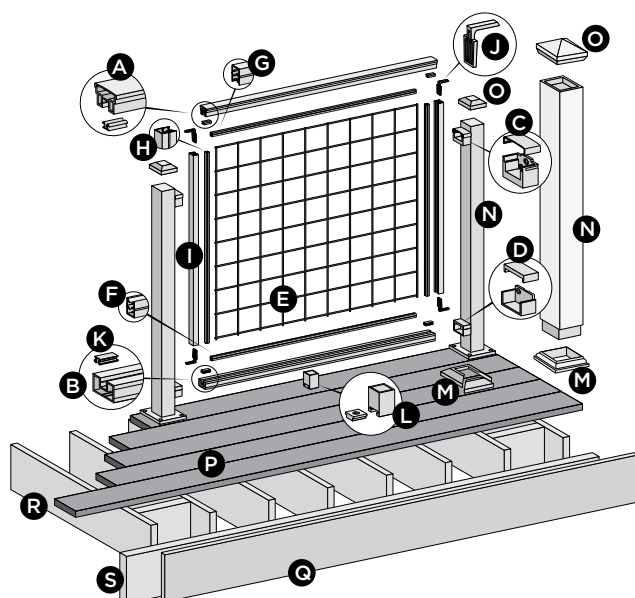

NOTE: IMAGE SHOWN HERE IS POST TO POST CONFIGURATION

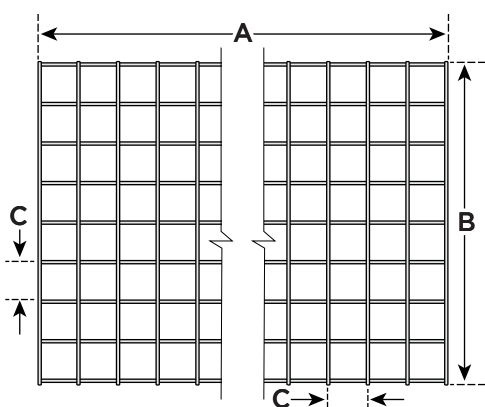

MESH DIMENSIONS CHART			
	A	B	C
6' x 36" HZ	64"	32 3/8"	4"
8' x 36" HZ	88"	32 3/8"	4"
8' x 42" HZ	88"	38 3/8"	4"
8' x 42" ST	108 3/16"	36 3/16"	4"

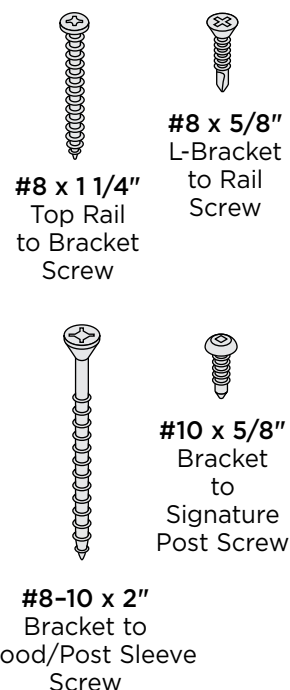

- A. Trex Signature Mesh top rail
 - 6' (actual length 73.5" [186.7 cm])
 - 8' (actual length 97.3" [247.7 cm])
- B. Trex Signature Mesh bottom rail
 - 6' (actual length 71.5" [181.6 cm])
 - 8' (actual length 95.5" [242.6 cm])
- C. Trex Signature upper rail bracket and cover
- D. Trex Signature lower rail tabless bracket and cover
- E. Mesh Panel - see chart above for dimensions
- F. Horizontal PVC Gasket
- G. Horizontal PVC Gasket
- H. Vertical PVC Gaskets
- I. Vertical Supports
- J. L-Brackets
- K. Snap-in Channel Filler
- L. Trex Signature foot block (REQUIRED FOR ALL SPANS - MESH INSTALLATIONS)
- M. Trex Signature post skirt or post sleeve skirt*

- N. Trex Signature post*
 - 36" (actual length 37" [94.0 cm])
 - 42" (actual length 43" [109.2 cm])
 or Trex 4" x 4" post sleeve**
 - 36" (actual length 39" [99.1 cm])
 - 42" (actual length 45" [114.3 cm])
- O. Trex Signature post cap or post sleeve cap*
- P. Trex decking
- Q. Trex Fascia
- R. Code-approved wood joist 2" x 8" (5.1 cm x 20.3 cm) or larger
- S. Code-approved wood rim joist 2" x 8" (5.1 cm x 20.3 cm) or larger

* Item not included in Trex Signature Railing kits.

** Both 4" x 4" (10.2cm x 10.2cm) and 6" x 6" (15.2cm x 15.2 cm) post sleeves are designed to fit over a 4" x 4" pressure treated post.

NOTE: If installing 42" (106.7 cm) railing, and using pressure-treated posts with Trex post sleeves, ensure that a longer pressure-treated post is used along with longer post sleeve, both cut to a height of 46" (116.8 cm) from decking surface.

TREX SIGNATURE® HORIZONTAL MESH RAILING

Installation Instructions

HOW TO INSTALL MESH RAILING

Installing Posts

REFER TO DETAILED INSTRUCTIONS ON HOW TO INSTALL TREX SIGNATURE POSTS OR PRESSURE TREATED POSTS.

NOTES:

- » FOR EASE OF INSTALLATION, IT IS RECOMMENDED TO USE THE TREX SIGNATURE RAIL TEMPLATES TO ATTACH BRACKETS (SOLD SEPARATELY).
- » TREX SIGNATURE POSTS (BLACK ONLY) CAN ALSO BE PURCHASED SEPARATELY WHICH HAVE BRACKETS PREINSTALLED, THUS SKIPPING STEPS 1-4 BELOW.

SKU NUMBER	DESCRIPTION
BKAL252537RCAPCNR	Signature Post 37" Corner Post
BKAL252537RCAPLINE	Signature Post 37" Inline Post
BKAL252543RCAPEND	Signature Post 43" End Post

SKU NUMBER	DESCRIPTION
BKAL252537RCAPEND	Signature Post 37" End Post
BKAL252543RCAPCNR	Signature Post 43" Corner Post
BKAL252543RCAPLINE	Signature Post 43" Inline Post

Attach Brackets Using Trex Signature Posts

TIP: Use a clamp to help hold brackets in place while fastening with screws.

1. Measure 1-3/8" (3.5 cm) from top of post base plate or 1-7/8" (4.8 cm) from decking surface. Mark with light line.

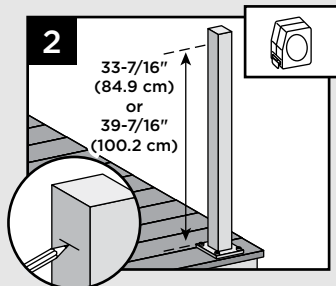
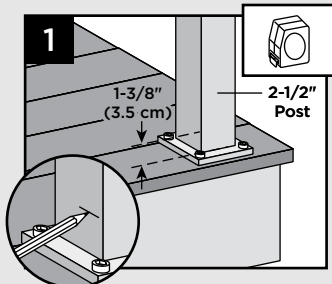

2. Measure up from post base plate 33-7/16" (84.9 cm) for 36" (92 cm) rail height or 39-7/16" (100.2 cm) for 42" (107 cm) rail height. Mark with light line.

NOTE: If measuring from decking surface, measure up 33-15/16" (86.2 cm) for 36" (92 cm) rail height or 39-15/16" (101.4 cm) for 42" (107 cm) rail height.

3. Center lower bracket on post **above** the marked line and attach using two self-tapping screws (provided).
4. Center upper bracket on post **above** marked line and attach using (3) self-tapping screws (provided).

NOTE: Upper bracket is not required on crossover post configuration.

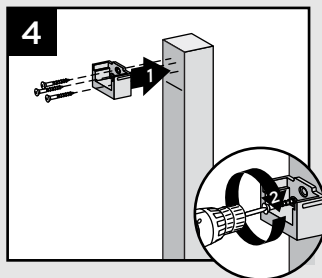

Attach Brackets Using Pressure-Treated Posts and Post Sleeves

TIP: Use a clamp to help hold brackets in place while fastening with screws.

1. Measure 1-7/8" (4.8 cm) up from deck surface to bottom of bracket. Slide skirt up to allow for proper measurement. Mark with light line.

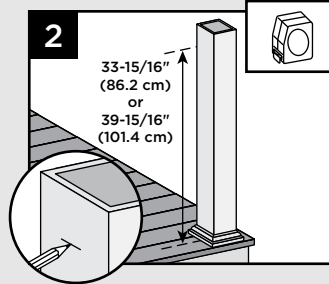
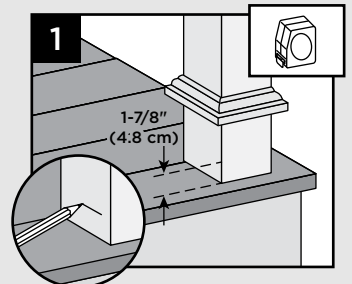

2. Measure up from decking surface 33-15/16" (86.2 cm) for 36" (92 cm) rail height or 39-15/16" (101.4 cm) for 42" (107 cm) rail height. Mark with light line.

NOTE: Push skirt back down onto surface of decking **BEFORE ATTACHING BRACKETS**.

3. Center lower bracket on post **above** the marked line and attach using two 2" (51 mm) wood screws (provided).
4. Center upper bracket on post **above** marked line and attach using three 2" (51 mm) wood screws (provided).

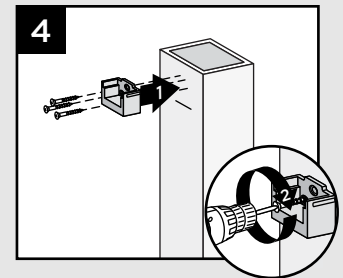

HOW TO INSTALL MESH RAILING/CONTINUED

How to Measure Bottom and Top Rails

For Full Span Post to Post Applications - only top rail will need to be cut. For Full Span Crossover to Crossover post Applications - no rails have to be cut.

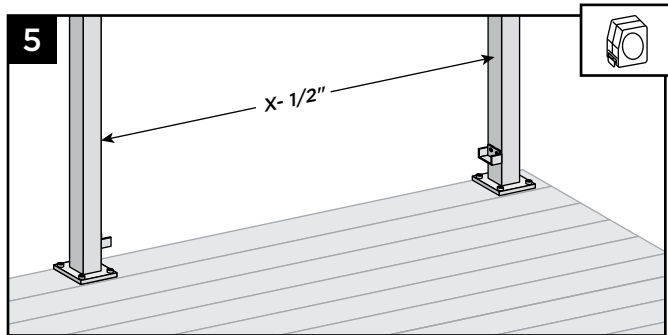

5. Measure distance between posts (X), and subtract 1/2" for bracket clearance.

If installing crossover post configurations, adjust top rail length: $X + 3/4"$ if using one crossover post, or $X + 1 1/2"$ if using two crossover posts.

If using swivel brackets, measure distance between brackets and cut railings to this distance. In addition, tab must be removed from bottom swivel brackets.

Cutting Rails

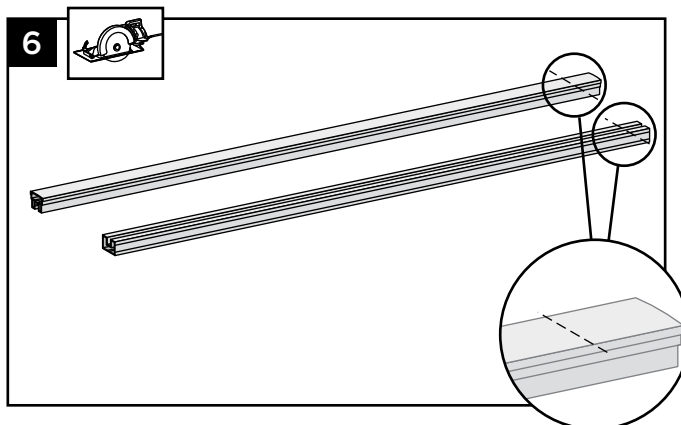

6. Cut both bottom and top rail to length as determined above.

Installing Bottom Rail and Adding Weep Holes to Bottom Rail

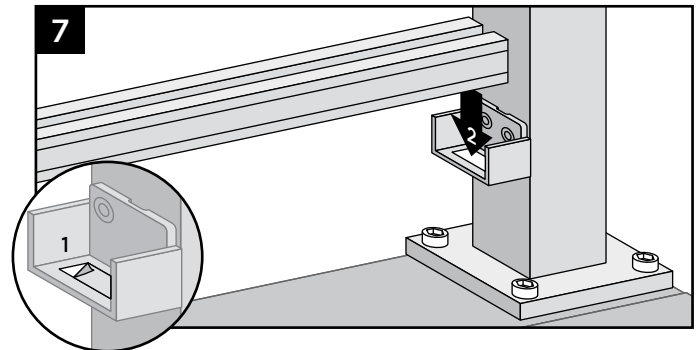

7. Place adhesive strips (provided) into bottom rail brackets, and then place bottom rail into brackets. Using a 3/8" drill bit, drill weep holes through center of bottom rail channel at 4 evenly spanned locations to allow for water drainage.

NOTE: Make sure surface is clean and dry.

Attachment of Foot Block (One Footblock is Required for Any Length Mesh Railing Span)

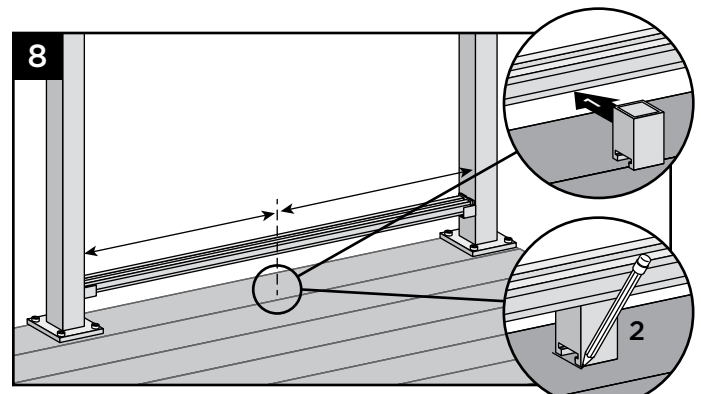

8. To ensure correct location, place foot block under center of bottom rail. Mark to provide placement location of base.

9. Place base (smaller side facing down) on decking surface. Attach base of foot block using one screw at an angle through base and into decking.

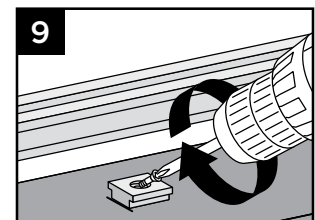

NOTE: Pre-drilling is recommended (1/8" [0.32 cm] drill bit) for attachment of base.

TREX SIGNATURE® HORIZONTAL MESH RAILING

Installation Instructions

HOW TO INSTALL MESH RAILING/CONTINUED

Cutting Mesh

(Required if installing rails at odd span lengths)

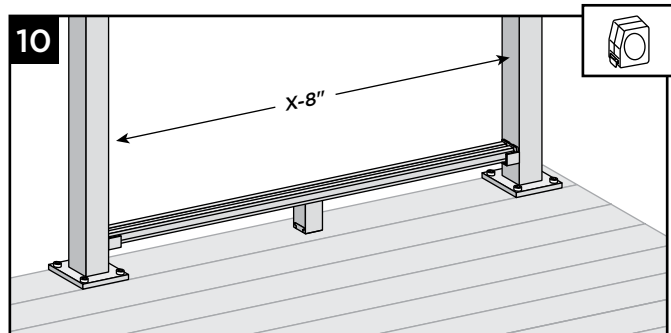

10. If not installing full span, mesh will require cutting from equal distance on each side. Measure distance between posts and subtract 8".

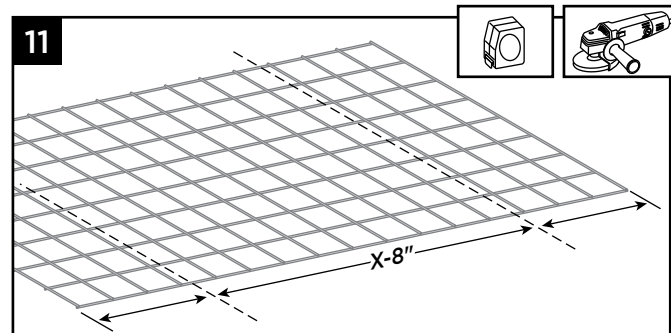

11. Cut mesh panel to this measurement, again cutting equal distances from each side so mesh is centered.

NOTE: An angle grinder (with proper blade) is recommended for cutting wire mesh. (ALWAYS USE PROPER SAFETY GEAR WHEN CUTTING WITH ANGLE GRINDER.) Note that heavy duty bolt cutters can also be used.

Cutting Bottom PVC Gasket & Installing onto Mesh

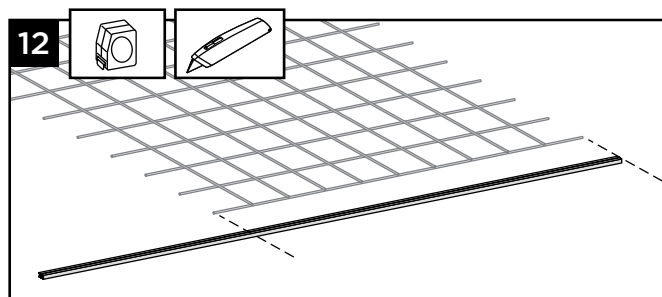

12. Cut bottom PVC gasket the same length as mesh panel.

4

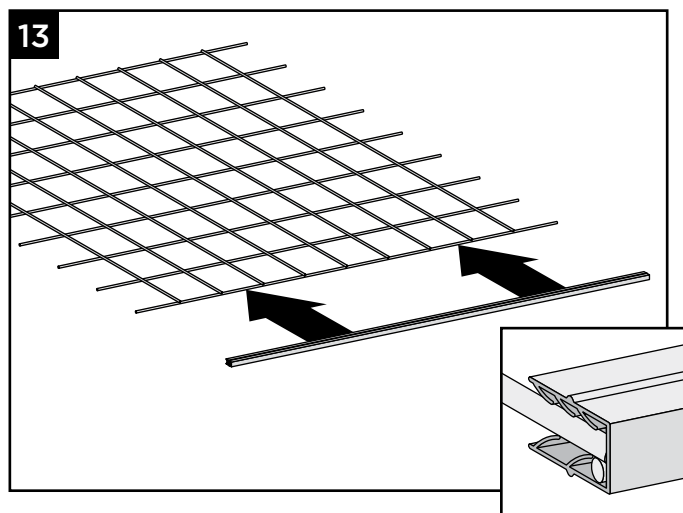

13. Install bottom PVC gasket onto bottom of mesh panel. Make sure gasket is fully seated onto mesh.

Centering the Mesh and Installing into Bottom Rail

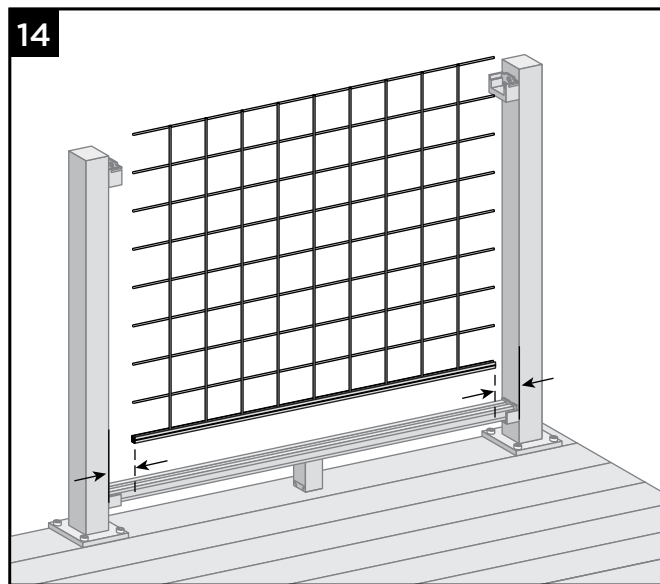

14. Center mesh (with bottom PVC gasket installed) so there is equal distance between sides of mesh and posts.

HOW TO INSTALL MESH RAILING/CONTINUED

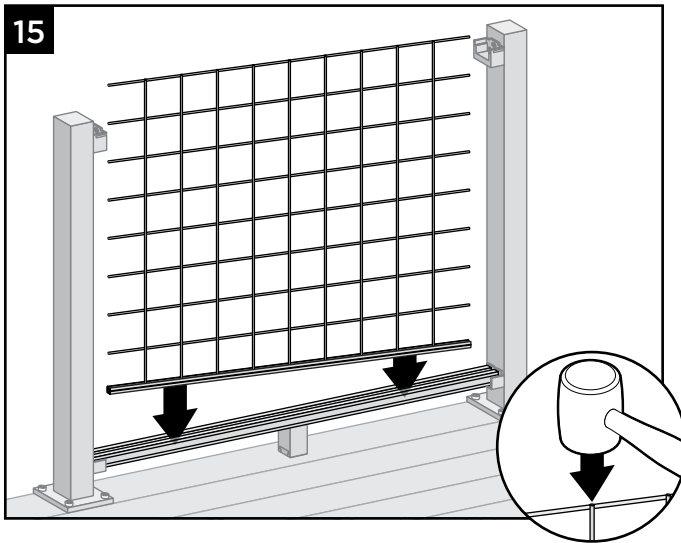

15. Starting at one end, push mesh (with bottom PVC gasket installed) firmly into the bottom rail. GENTLE tapping with rubber mallet on mesh CROSS-SECTIONS will help prevent mesh from bending.

NOTE: Make sure mesh is being secured by hand until final assembly of the top rail.

Installing Vertical PVC Gaskets onto Mesh (No cutting required these come standard size.)

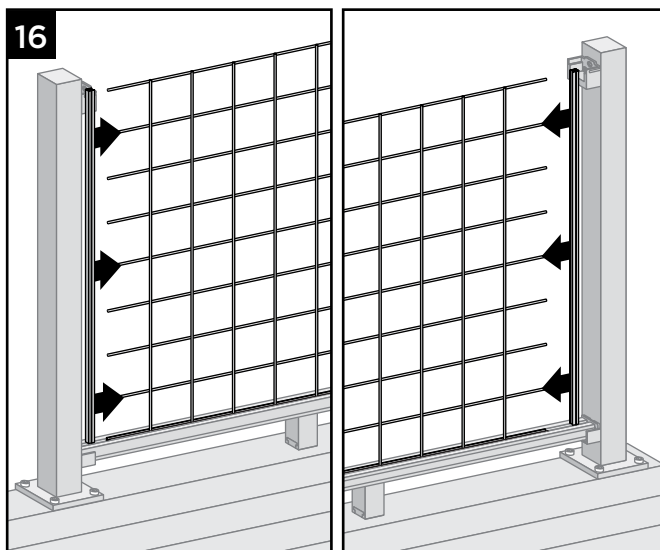

16. Install vertical PVC gaskets onto each side of mesh, ensuring that bottom of gaskets are resting on surface of bottom rail. Make sure that gaskets are fully seating onto the mesh.

Installing L-Brackets into Vertical Supports

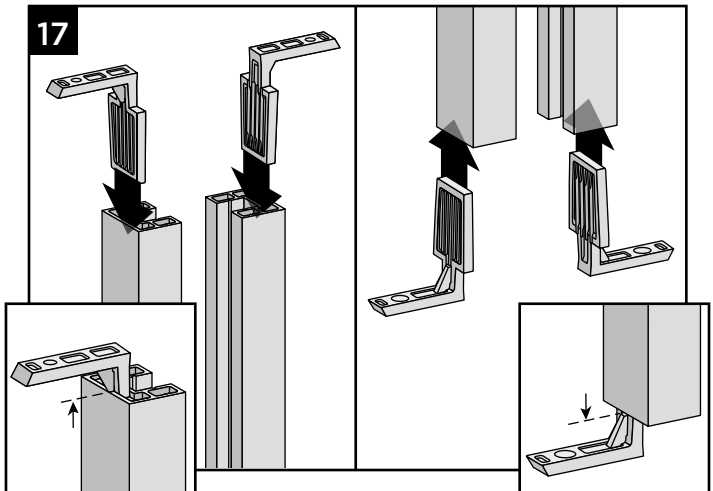

17. Install L-brackets into both top and bottom slots of vertical supports as shown. L-brackets will require light tapping until stop lip of bracket is resting on vertical support.

Installing Vertical Supports

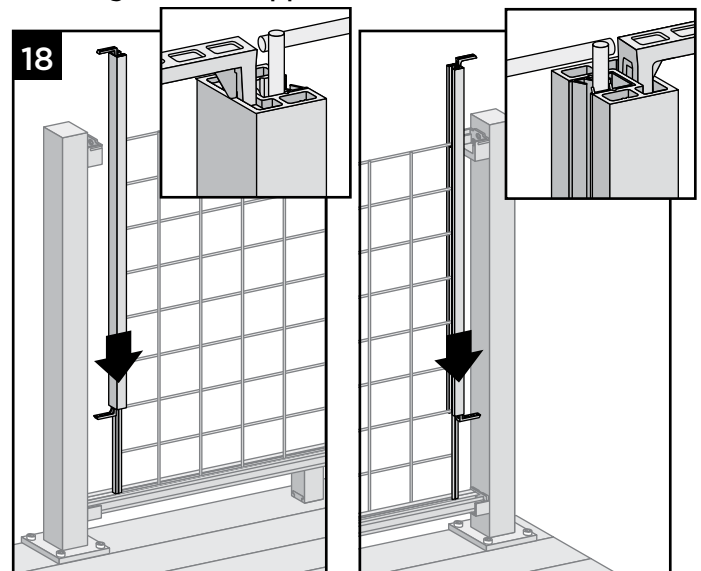

18. Install vertical supports onto vertical PVC gaskets, also ensuring that L-bracket is fully seated into bottom rail channel. Light tapping with rubber mallet may be required.

TREX SIGNATURE® HORIZONTAL MESH RAILING

Installation Instructions

HOW TO INSTALL MESH RAILING/CONTINUED

Cutting Top PVC Gasket & Installing onto Mesh

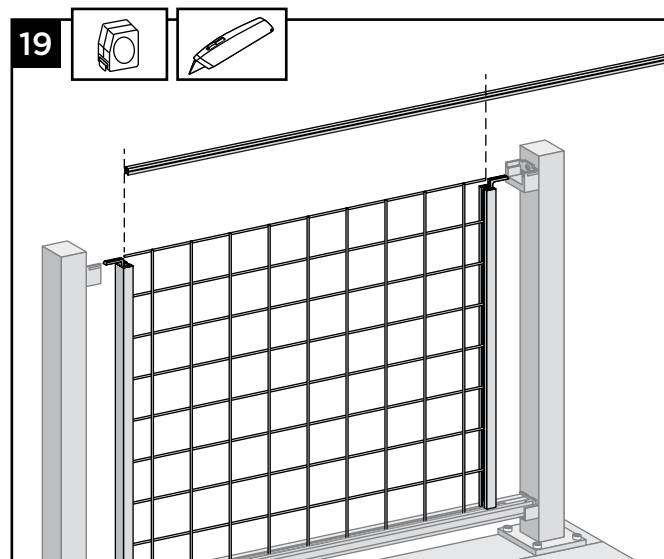

19. Cut top PVC gasket the same length as mesh panel.

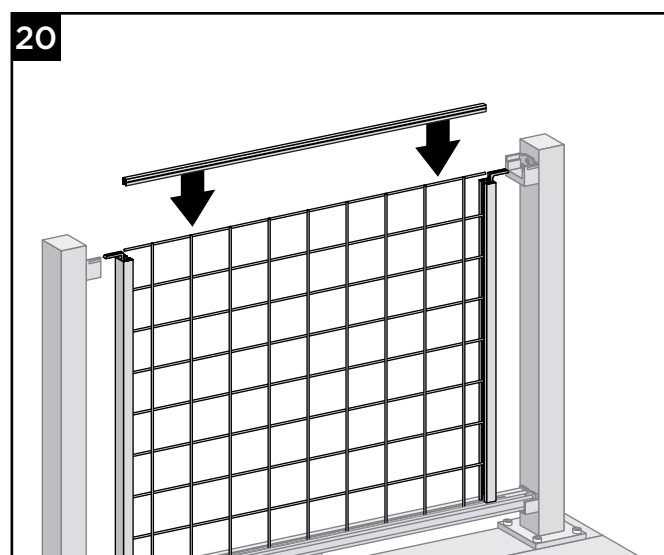

20. Install cut gasket onto top of mesh panel. Make sure gasket is fully seated onto mesh.

Installing Top Rail onto Mesh Panel

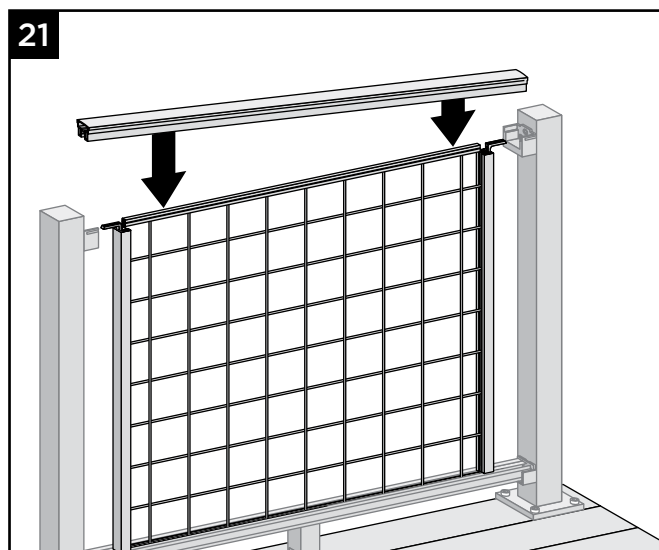

21. Starting at one end and working down, press the top rail firmly onto the top of the mesh panel (with top PVC gasket on mesh). Ensure the top rail is centered properly so top rail will seat into brackets when finished.

Attaching L-Brackets to Top and Bottom Rails

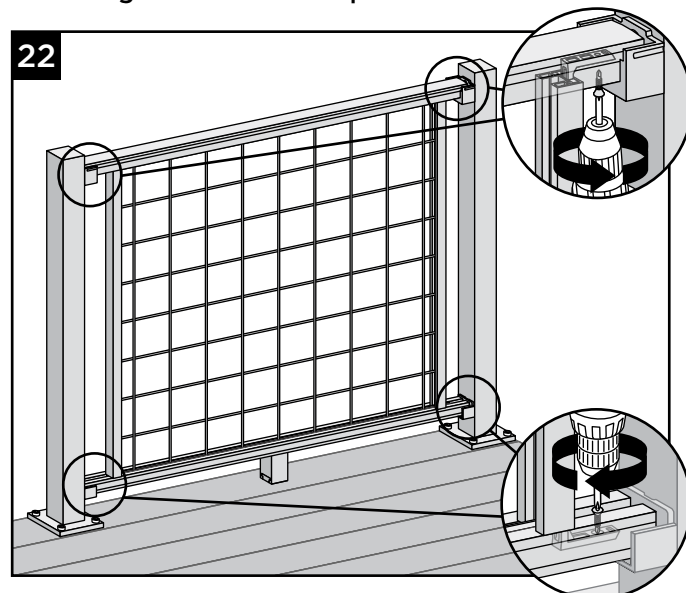

22. Attach L-Brackets to both top and bottom rails using one #8 x 5/8 flat head screw (provided).

HOW TO INSTALL MESH RAILING/CONTINUED

Attaching Top Rail to Brackets

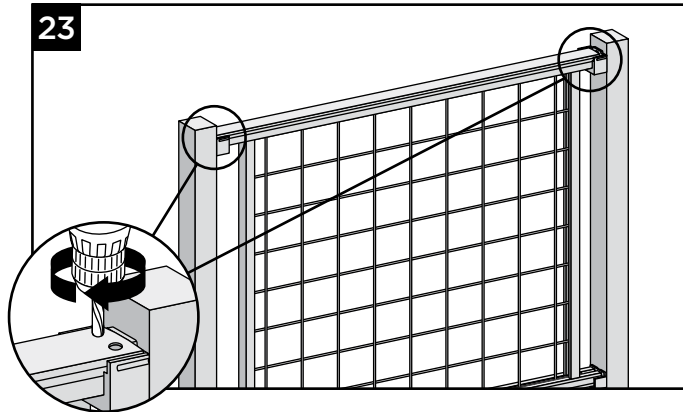

23. Drill two 1/2" holes approximately 1/2" from end of top rail. Repeat this on opposite side of top rail.

NOTE: HOLES CANNOT EXTEND PAST BRACKET, OTHERWISE BRACKET COVER WILL NOT COVER HOLES.

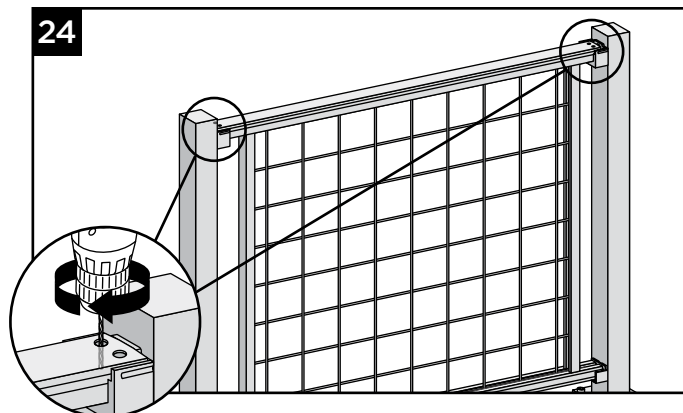
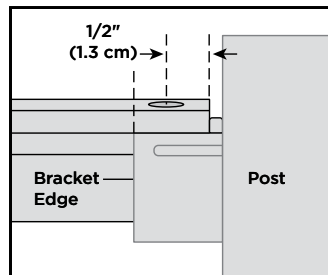

24. Using 9/64" bit provided, center into above holes and **PREDRILL** into top rail bracket at a depth of approximately 1-1/4". Use care to not drill through underside of top bracket.

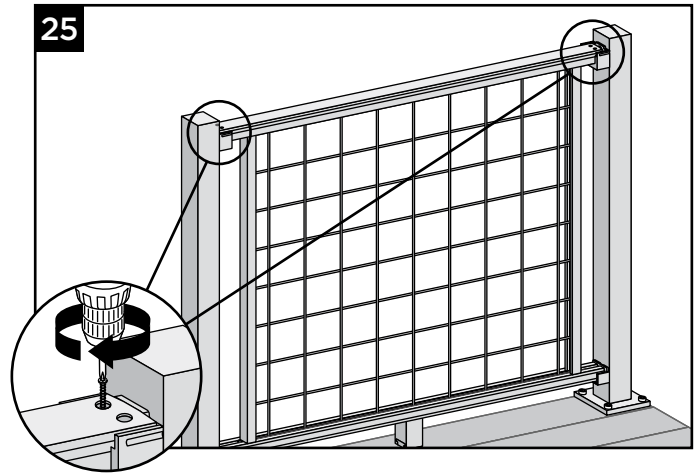
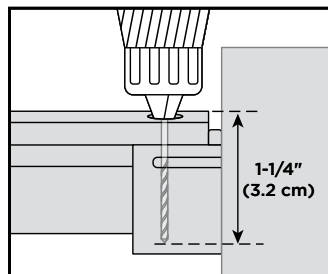

25. Install two #8 x 1-1/4" screws provided into top rail and top bracket on each end of top rail.

Installing Snap-in Channel Filler

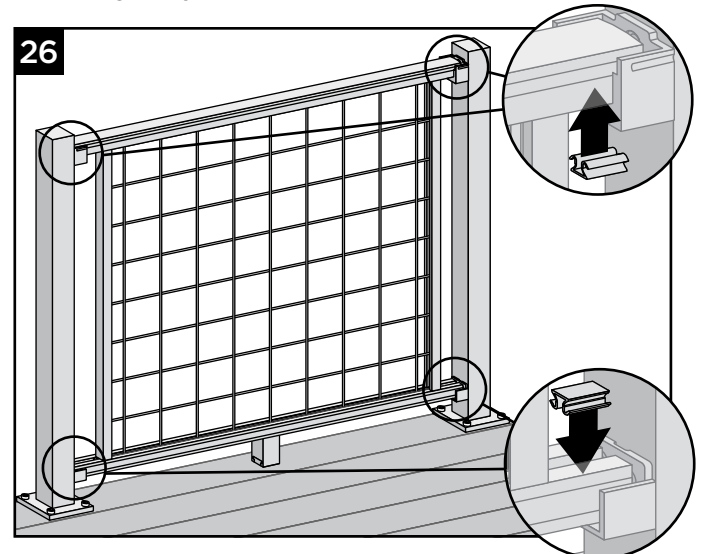

26. Cut snap-in channel filler to correct length and install into channels of bottom and top rails. Use of a rubber mallet may assist with this step. **DO NOT** attempt to cut short snap in pieces with a miter saw. Use an angle grinder or hack saw only.

TREX SIGNATURE® HORIZONTAL MESH RAILING

Installation Instructions

HOW TO INSTALL MESH RAILING/CONTINUED

Attachment of Bracket Covers, Skirts, and Caps

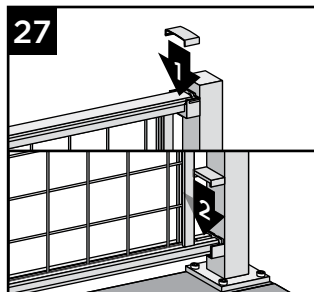

27. Attach corresponding bracket covers over opening in upper and bottom rails.

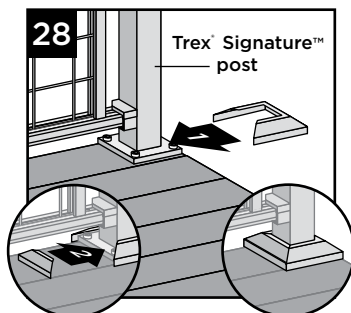

28. Attach provided post skirt to bottom of posts when using Trex Signature posts.

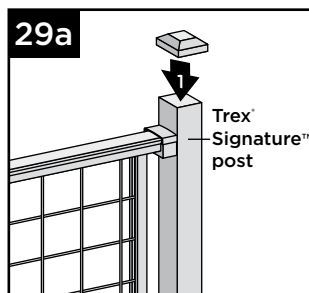

29a. Attach post caps to Trex Signature posts.
(Use of **rubber mallet** may be required for secure attachment.)

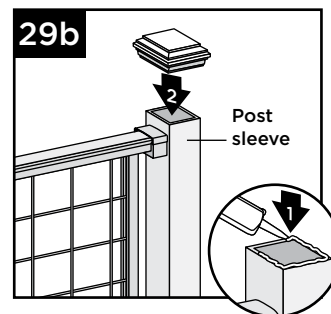

29b. Attach post caps to post sleeves using external grade PVC construction adhesive.